

Thames Street, Windsor - traffic improvements

Royal Borough residents, local businesses, Windsor Castle and motorists are to be asked for their views on possible changes to the traffic flow in the area of Thames Street in front of Windsor Theatre Royal. This is because of traffic congestion in that part of Windsor.

Two proposals are under consideration in response to pleas from local businesses and are part of the council's ongoing commitment to freeing up congestion in the roads around Windsor. The present restrictions mean that vehicles approaching the town centre from Datchet are banned from travelling uphill on Thames Street past the castle and must continue along Barry Avenue and into the surrounding roads, adding to local congestion.

The main proposal

would be to create one-way traffic movement around the front and back of the Theatre Royal (as shown on the plan on the right).

The alternative is to reintroduce two-way traffic for cars in Thames Street in front of the theatre and reverse the traffic direction on River Street for cars only (as shown below).

Cllr Colin Rayner, lead member for highways and street-care, said: "Local businesses and the Chamber of Commerce believe that by improving the movement of traffic in this area we can alleviate some of the

Please tell us what you think

traffic jams around the outer town centre. This would also encourage more people into the town centre itself to enjoy the shops, cafes and restaurants.

"We do have concerns about the speed of cars going up Thames Street towards the castle.

"Any scheme will be designed sympathetically to take into account the needs of the many pedestrians who enjoy the town centre.

There will be no changes to any of the bus routes or stops.

"We want to hear the views of as many people as possible who live or work in the area to enable us to make a decision based on what people really want.

"We are committed to easing congestion and supporting the town centre and are determined to work towards a practical solution – so please take the time to tell us what you think.

"No decisions will be made until full consultation has taken place and the traffic model has been run through our computer systems.

"We need to know what people think before we go to the next stage and carry out a further full public consultation with various options and costs."

You can take part in the consultation by answering the questions below.

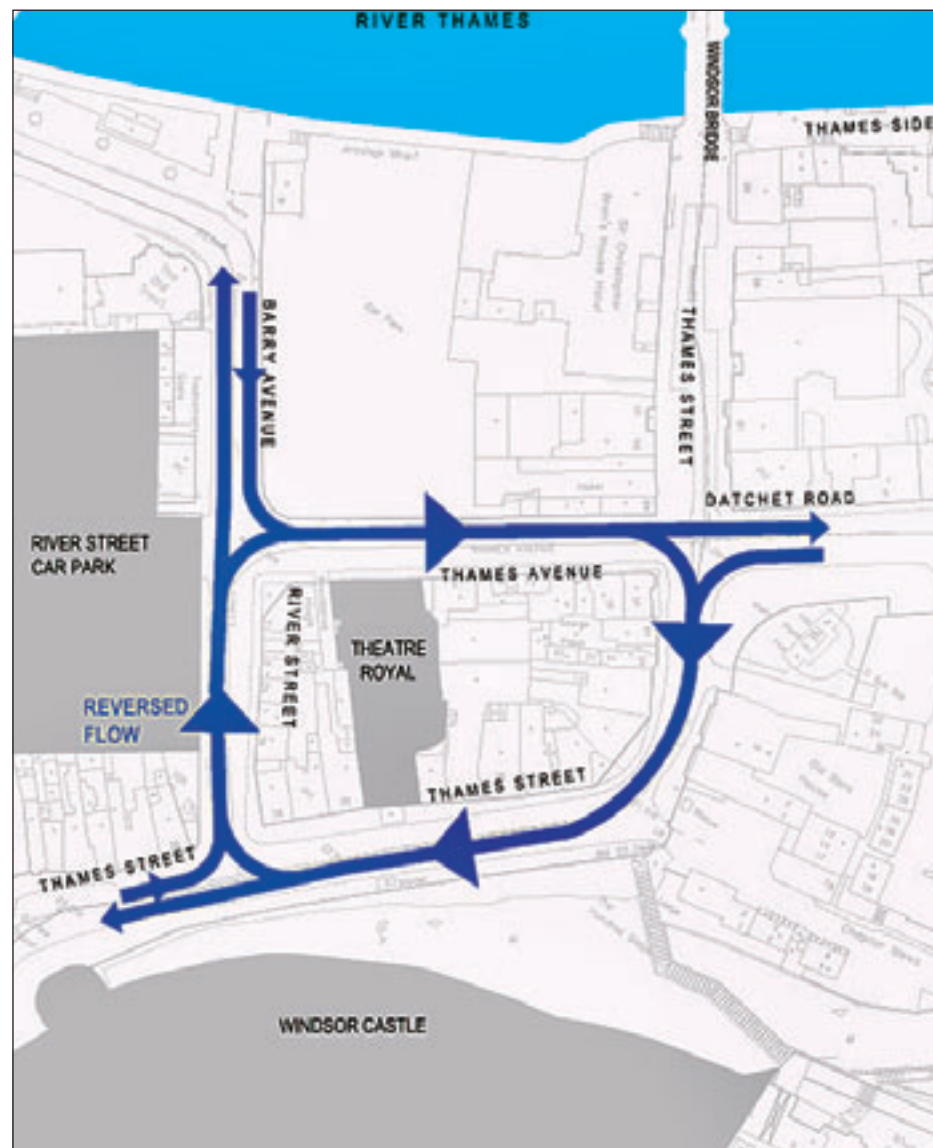

MAIN PROPOSAL (ONE-WAY)

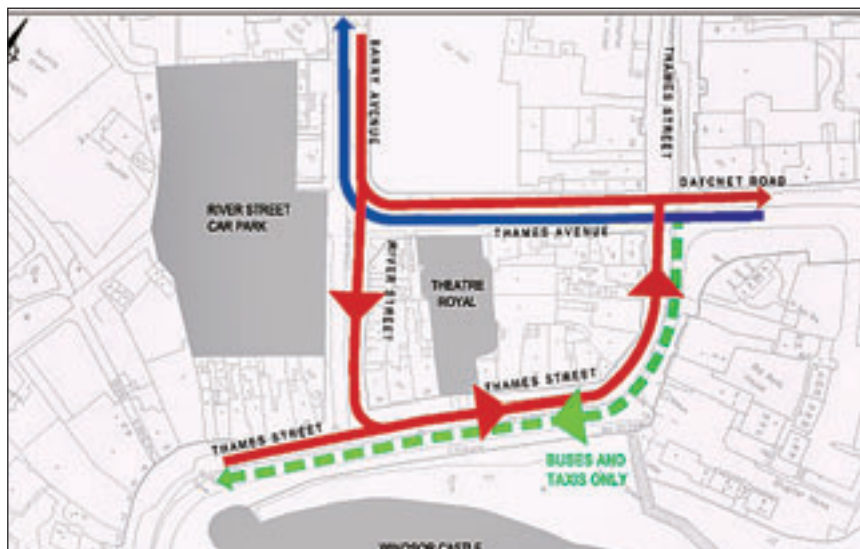

EXISTING TRAFFIC FLOW

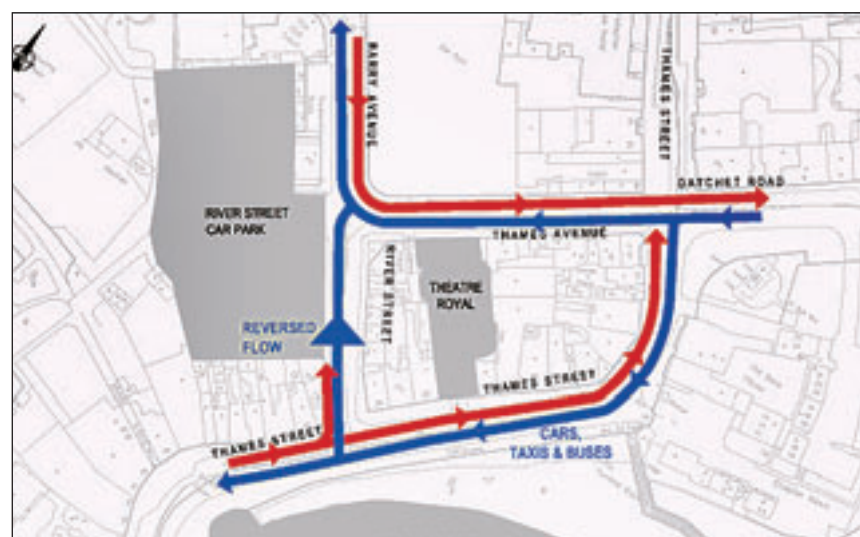

ALTERNATIVE PROPOSAL (TWO-WAY)

'We are committed to easing congestion and achieving a practical solution.' Cllr Colin Rayner

HAVE YOUR SAY

● Do you agree that the council needs to take measures to improve traffic movement in Thames Street in front of Windsor Theatre Royal? YES NO

● Do you support the council's main proposal? YES NO

● Do you support the council's alternative proposal? YES NO

● Which of the two proposals do you think would have the greatest benefit in reducing congestion and supporting the town centre? MAIN PROPOSAL ALTERNATIVE PROPOSAL

ADDITIONAL COMMENTS: Do you have any other comments or suggestions to alleviate the congestion problem? (Please use additional sheets if necessary).

.....

.....

.....

You do not need to provide your name and address but your postcode will help with our response analysis.

POSTCODE:

Please send your responses to Thames Street Consultation, FREEPOST RLYH-SHYR-JUXJ, Royal Borough of Windsor and Maidenhead, Town Hall, St Ives Road, Maidenhead, Berkshire SL6 1RF. Take part online at www.rbwm.gov.uk or write to the Traffic and Road Safety team at the address above. Closing date: **Friday 30 November.**